

# Easy Plumbing Fixes



# Estimated Water Savings

A family of 4 could save:

- 200 gpd by fixing **toilet leaks**
- 20 gpd by fixing **faucet leaks**
- 100 gpd by installing **low-flow showerheads**
- 40 gpd using **faucet aerators**



*gpd = gallons per day*

# Checking/Testing for Water Leaks

- Check your winter water use
  - A family of four might have a leak if winter water use exceeds 12,000 gallons per month
- Check your water meter before and after a two-hour period when no water is being used.



# Checking/Testing for Water Leaks

Click [HERE](#) for a video on how to check for leaks, read you water meter and turn off your home's water at the meter.



# Replacing a Toilet Flapper

## Tools/Materials Needed:

- Channel lock or Crescent wrench
- Flapper Valve

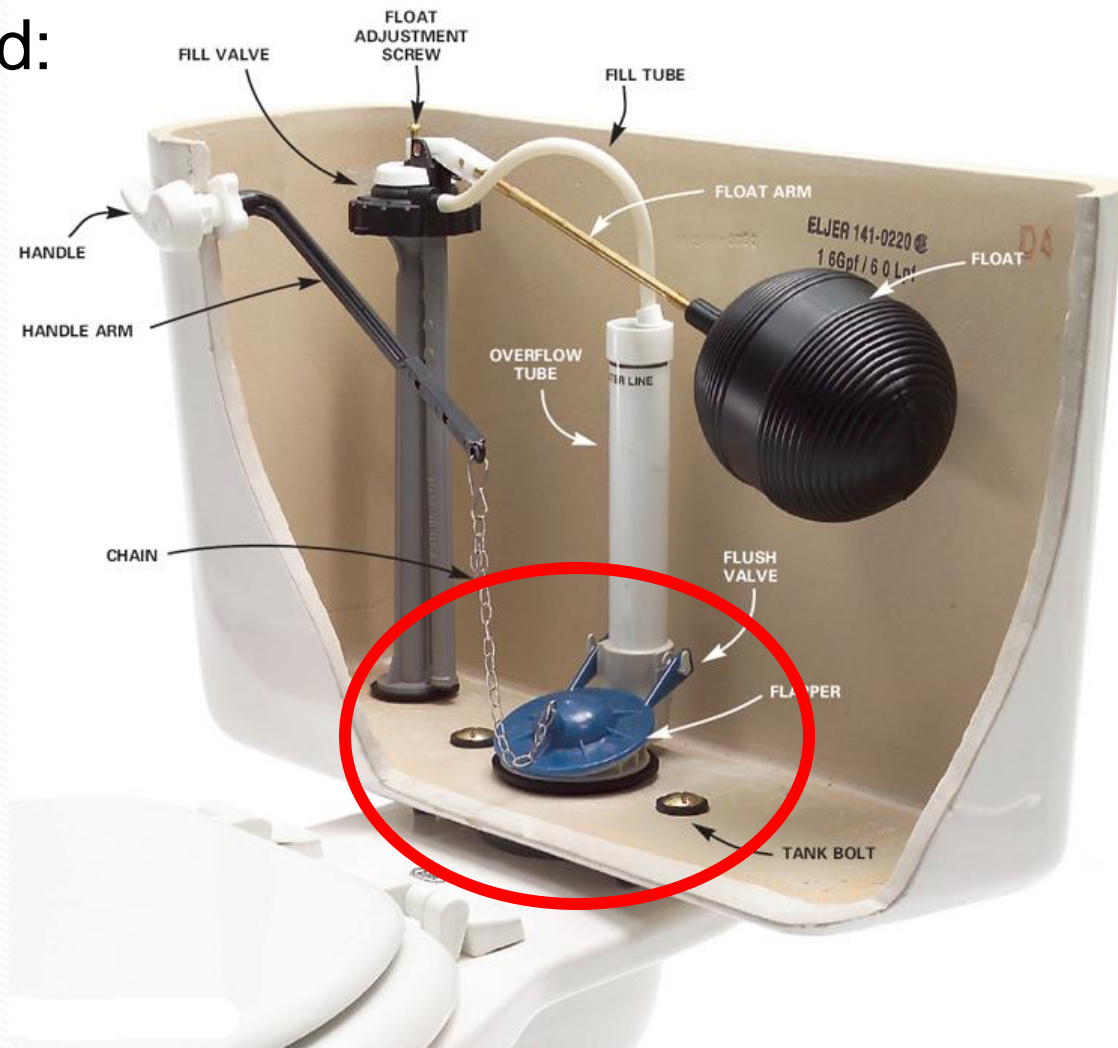

# Replacing a Toilet Flapper

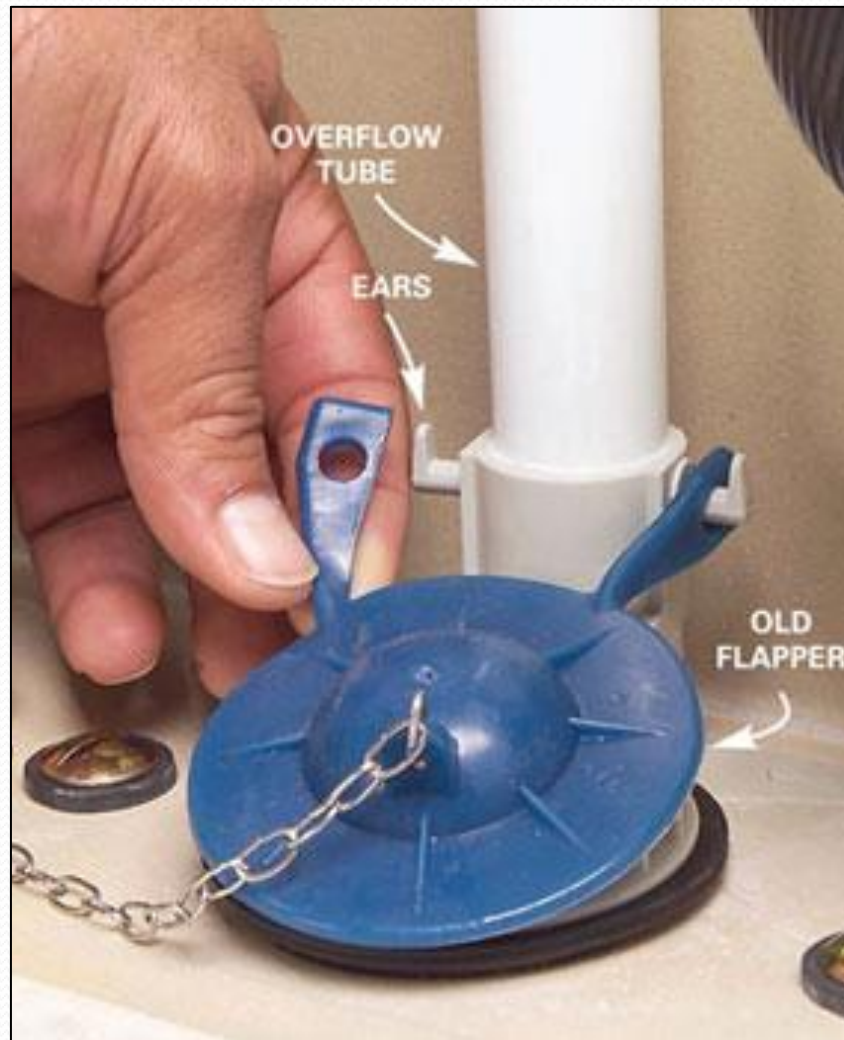

# Replacing a Toilet Flapper

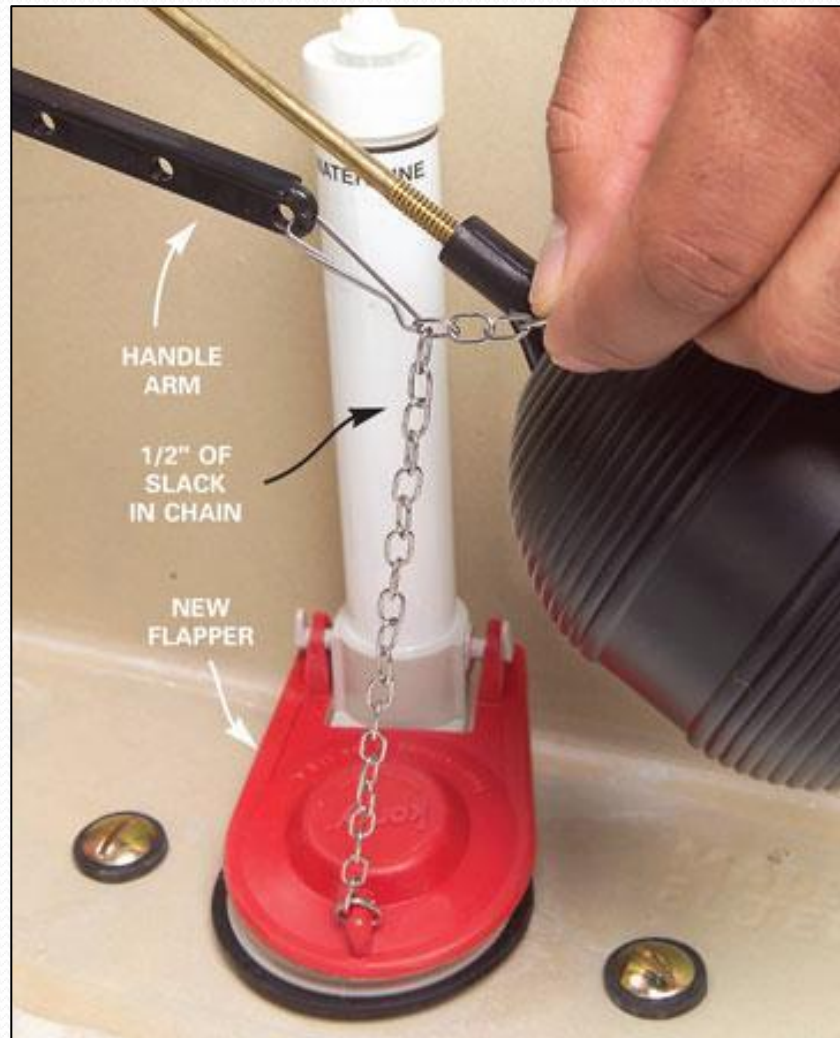

# Replacing a Toilet Flapper

Click [HERE](#) for a video tutorial on how to replace a toilet flapper.



# Replacing a Toilet Fill Valve

Tools/Materials Needed:

- Channel lock
- Fill Valve



# Replacing a Toilet Fill Valve



Turn off the water supply, flush the toilet, and sponge the remaining water from the tank.

Disconnect the water supply line, unscrew the fill valve locknut.



# Replacing a Toilet Fill Valve



# Replacing a Toilet Fill Valve



Prepare the new fill valve by adjusting the height of the fill valve as necessary.

*TIP: You want the fill valve to be slightly taller than the over flow tube but not so tall that it will prevent the tank lid from closing.*



# Replacing a Toilet Fill Valve

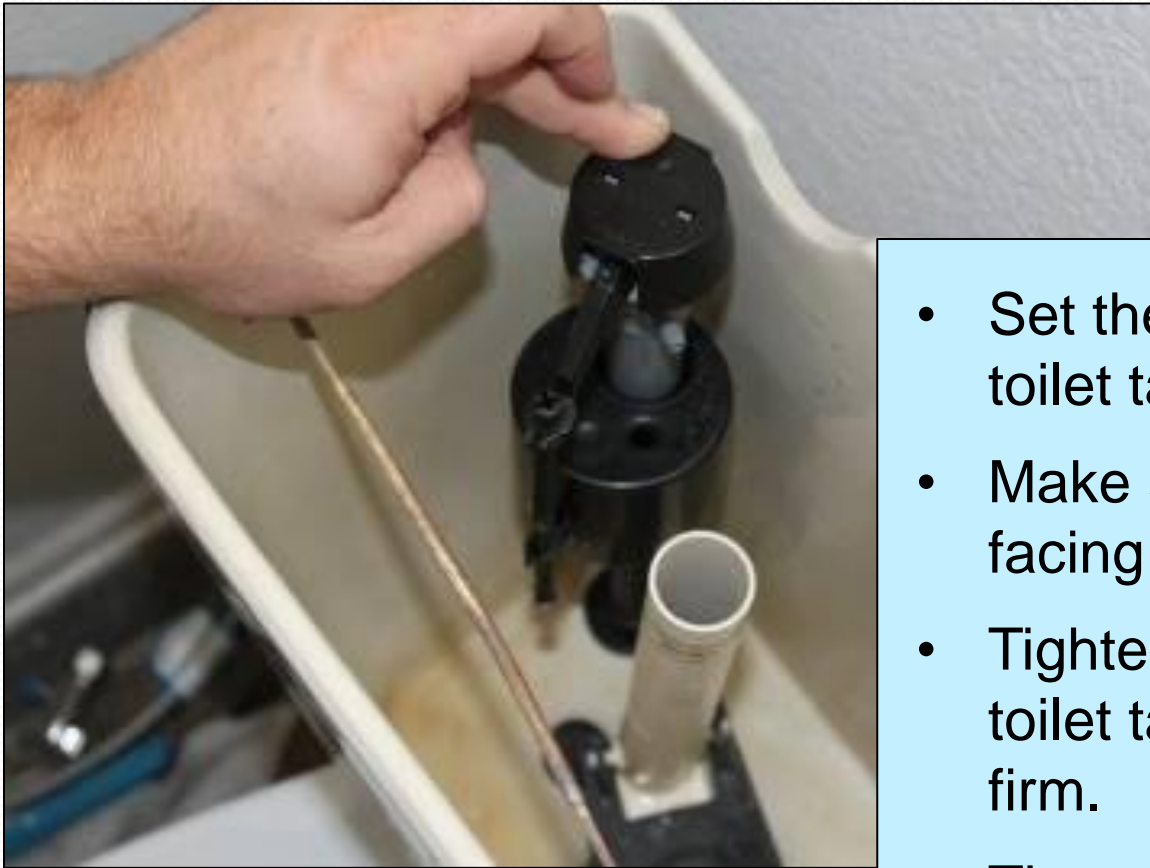

- Set the fill valve into the toilet tank.
- Make sure the nipple is facing the overflow tube.
- Tighten the nut under the toilet tank by hand until firm.
- Then use pliers to tighten just a little more.



# Replacing a Toilet Fill Valve

- Cut rubber hose to length and connect to the fill tube.
- Clip onto the overflow pipe.
- Turn water back on and check for leaks under the toilet tank.
- Adjust the water level appropriately for your toilet. The tank should fill to marked water line.

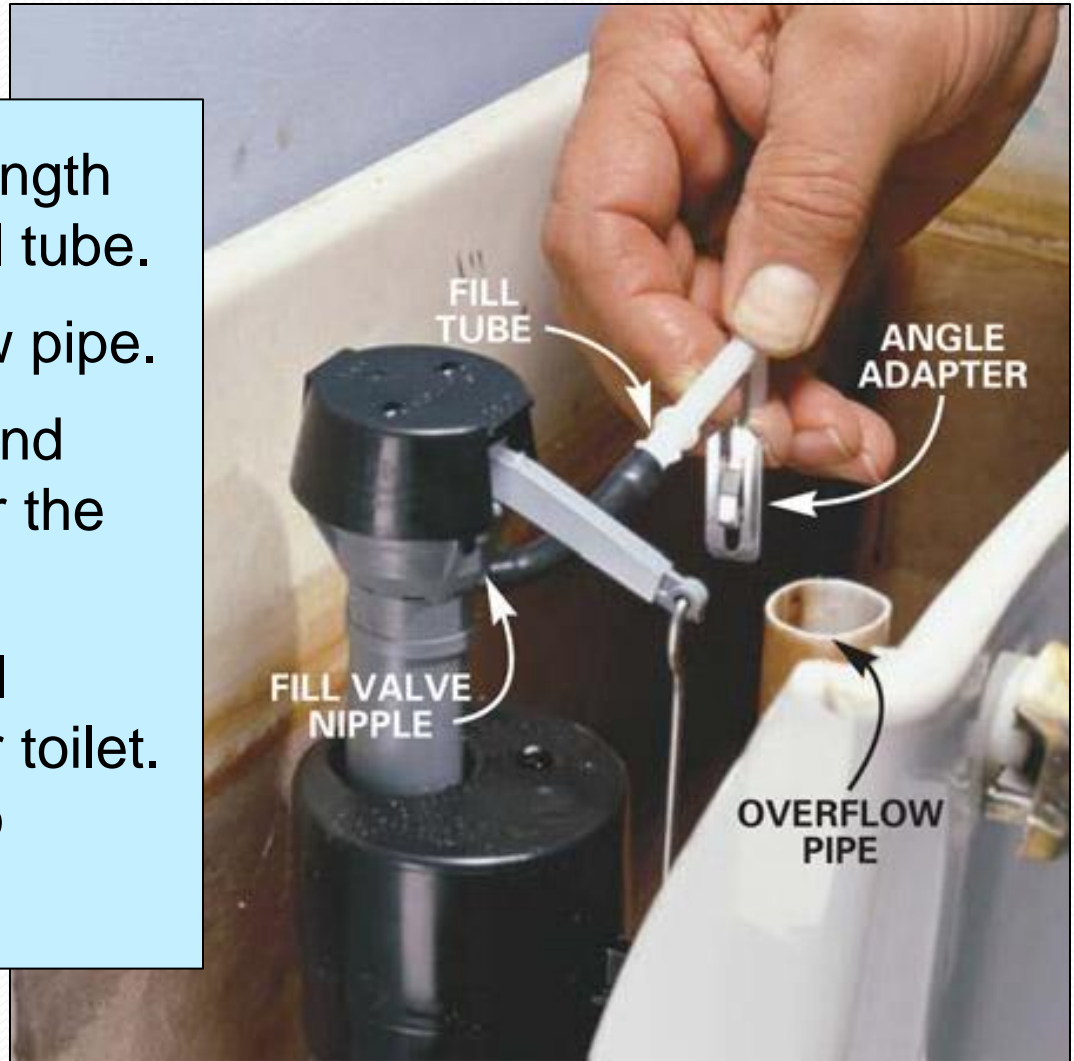

# Installing a Low-Flow Showerhead

## Tools/Materials Needed:

- Channel lock
- Rag/towel
- Low-flow showerhead
- Teflon tape



# Installing a Low-Flow Showerhead

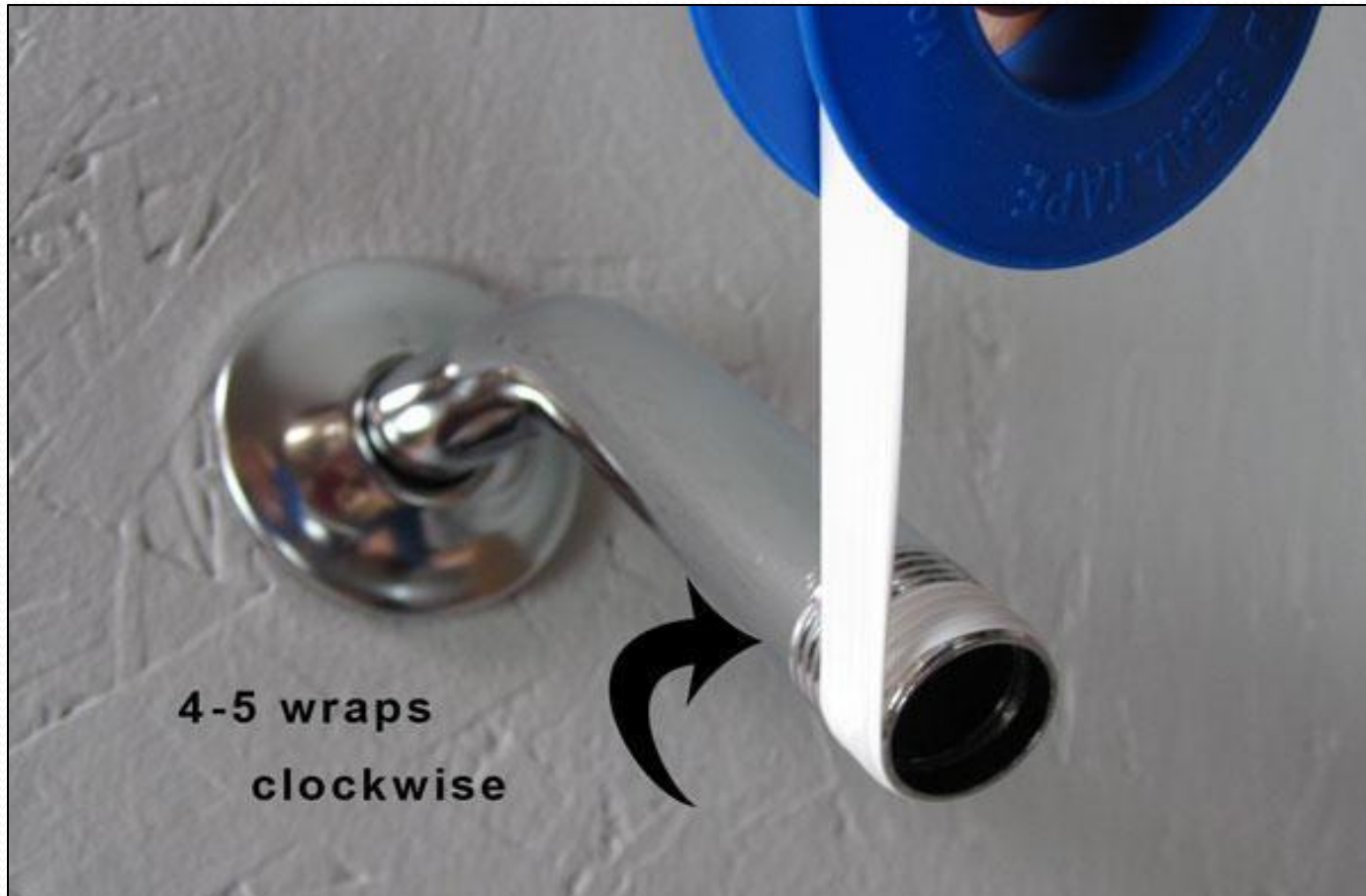

Wrap Teflon tape around shower arm threads 4 – 5 times in a clockwise direction.

# Installing a Low-Flow Showerhead





# Installing a Low-Flow Showerhead





# Installing a Low-Flow Showerhead

Click [HERE](#) for a video tutorial on how to install a low-flow showerhead.

# Fixing a Leaky Faucet

## Tools/Materials Needed:

- Channel lock
- Allen wrench set
- Phillips screwdriver
- Faucet cartridge/washer



# Fixing a Leaky Faucet



# Fixing a Leaky Faucet



# Fixing a Leaky Faucet





# Fixing a Leaky Faucet

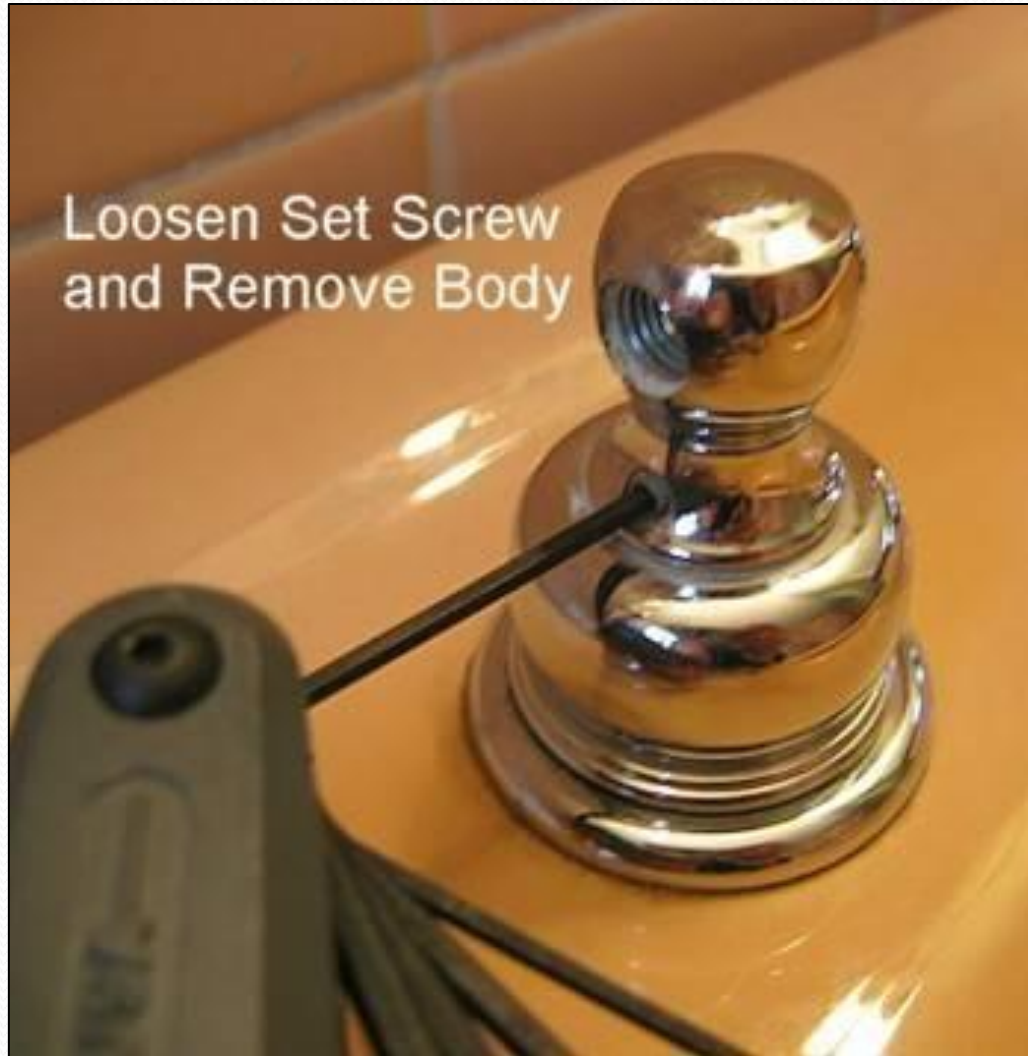

# Fixing a Leaky Faucet



Loosen retaining ring and remove.

# Fixing a Leaky Faucet



# Fixing a Leaky Faucet



Take this part to a plumbing supply store to match the exact model.

# Fixing a Leaky Faucet





# Fixing a Leaky Faucet

Click [HERE](#) for a video tutorial on how to fix a leaky faucet.

# Installing an Aerator

Tools/Materials Needed:

- Channel lock/Crescent wrench
- Rag/Towel
- Aerator

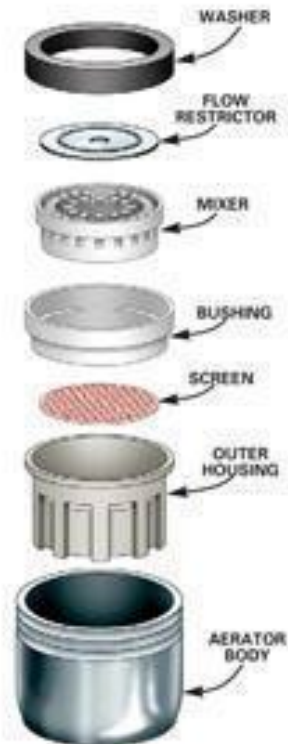

# Installing an Aerator



Remove existing aerator if replacing. Use channel locks or crescent wrench to loosen.

# Installing an Aerator



Install new aerator and tighten by hand. Use channel locks or crescent wrench to tighten once quarter turn more.

# Installing an Aerator

Click [HERE](#) for a video tutorial on how to install a faucet aerator.



# Fixing a Leaky Hose Bib

Tools/Materials Needed:

- Channel lock/Crescent wrench
- Phillips screwdriver
- Packing nut/washer



# Fixing a Leaky Hose Bib

Click [HERE](#) for a video tutorial on how to fix a leaking hose bib (outdoor faucet).



# Repairs that may require a plumber...

- Toilet replacement
- Water heaters
- “Sweating” copper pipes
- More substantial leaks



# Plano Water Conservation Programs

## Indoor

- Free Water Conservation Retrofit Items
- Toilet Rebate Program

## Outdoor

- Rain/Freeze Sensor Rebate
- Rain Barrel Rebate
- Summer classes & workshops  
[livegreeninplano.obsres.com](http://livegreeninplano.obsres.com)



# Questions?

- Details on water conservation programs, including rebates & free items visit [plano.gov/water](http://plano.gov/water)
- Questions about your bill or water use?  
Customer & Utility Services 972-941-7105
- Upcoming class schedule & registration [livegreeninplano.obsres.com](http://livegreeninplano.obsres.com)